

Modular Operation Theatre

SIT is specialized in turnkey modular high-tech environments.

A strong partnership with ADMECO AG, a supplier of Laminar Flow Filter System and Operation Theatre Infrastructure, guarantees the necessary know-how regarding the surgical and medical field.



Prefabricated units in container system reduce the time involved in the construction phase and guarantee continuous high quality. Our system can be attached to an existing building; the modules can withstand all climate conditions.



No crane is needed for loading or unloading modules from the low bed truck. Different tools are available for handling, such as hydrofoil planks, trolley jacks, etc.

The SIT modules are constructed with steel frame support. To withstand the required climate condition the outer shell can be insulated.

SIT is a key supplier for high tech environments. The same team is in charge from the construction phase through to the unit's acceptance. When you choose SIT you work with one partner. You won't need to bother with subcontractors, consultants and construction companies.

Cross-Cut Section of Modular Operation Theatre

The SIT modular Operation Theater can be independently operated. The infrastructure module can be fitted according to customer requirements with:

- A diesel electrical generator
- Air conditioning
- Medical gas supply
- Water purification

The infrastructure module is decoupled to avoid vibration of the Operation Theater.

The Operation Theater consists of three modules. The Operation Room has a size of 7.5m x 5.6m. The Laminar Airflow is controlled within a 3.0m x 3.4m area.

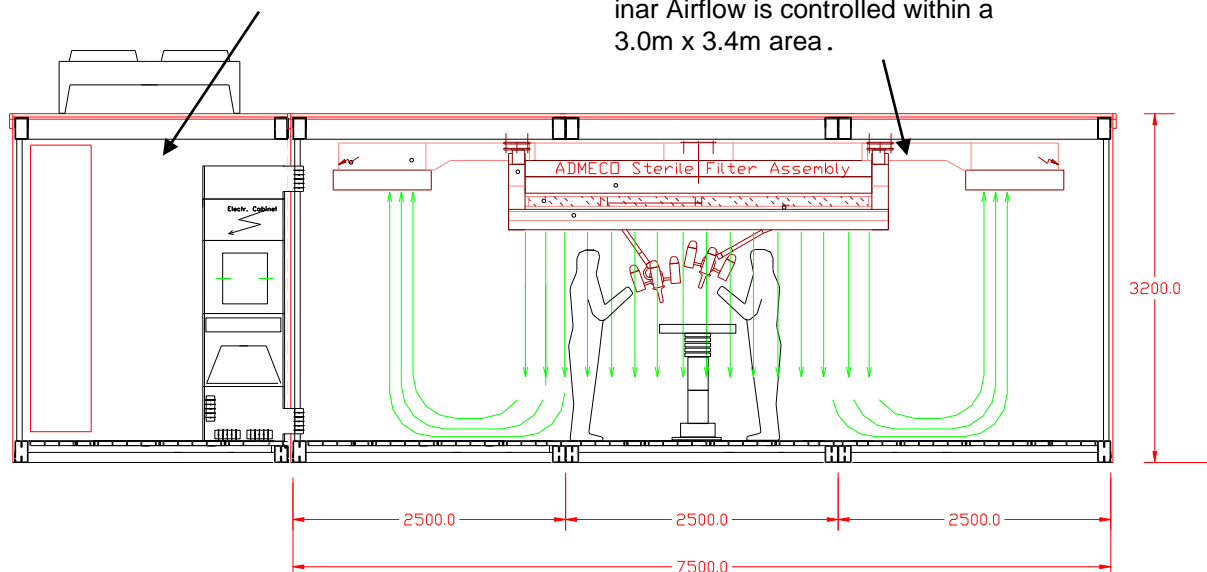

Modular Operation Theatre Layout For Hospital-Use

Measuring 2.5m x 12m x 3.2m the modules are equal in size to a 40ft transportation container. Therefore standard truck transportation and handling equipment can be used. A height of 3.2m must be considered for road transportation.

The infrastructure module is decoupled to preclude vibration.

Three modules are hooked together, consisting of all required apparatus and rooms for sterilization, disinfection, packaging, toilet, lockers, wake-up and holding.

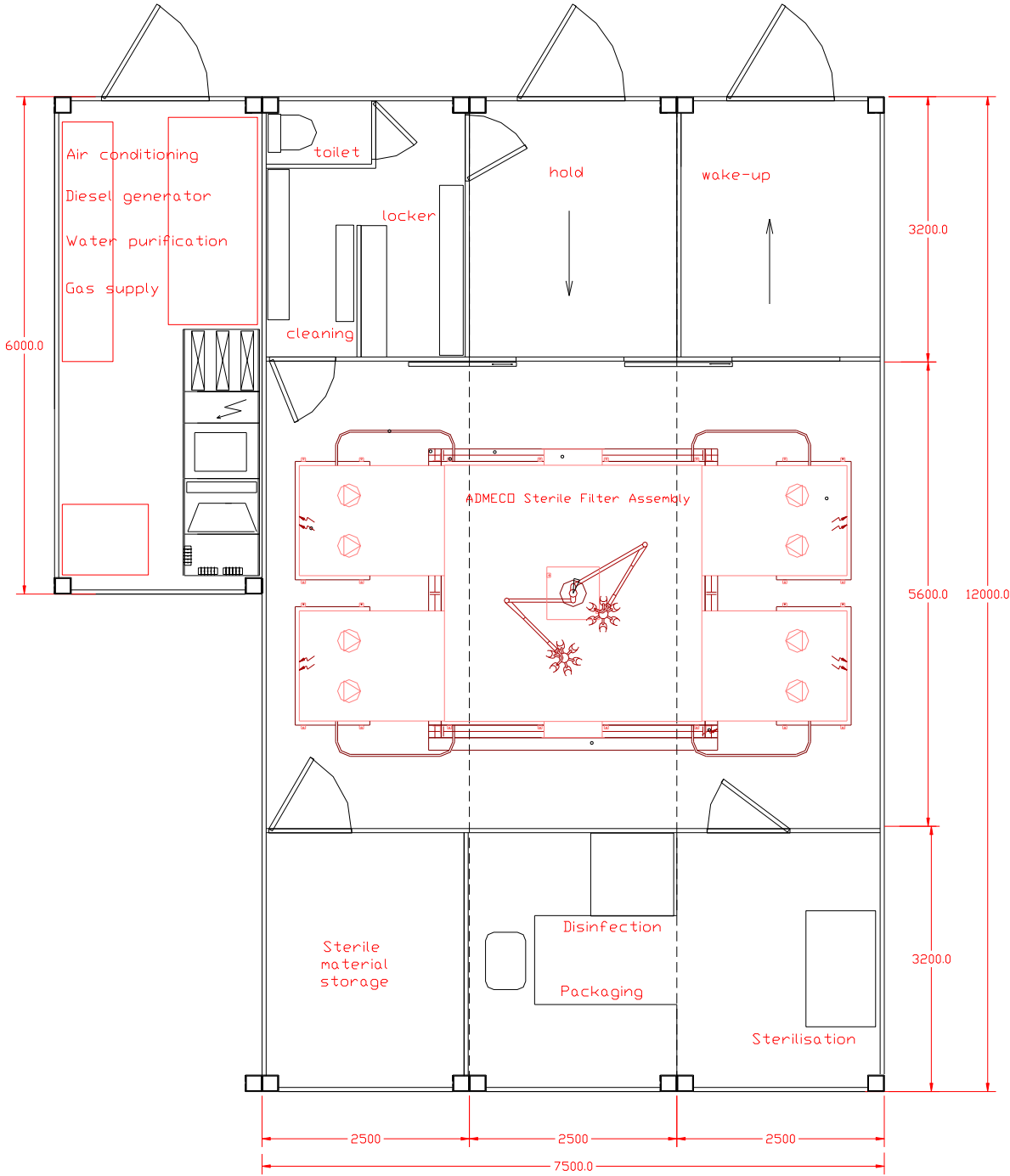

Modular Operation Theatre Layout

The room walls are formed by removable honeycomb panels with a conductive epoxy roll coat finish.

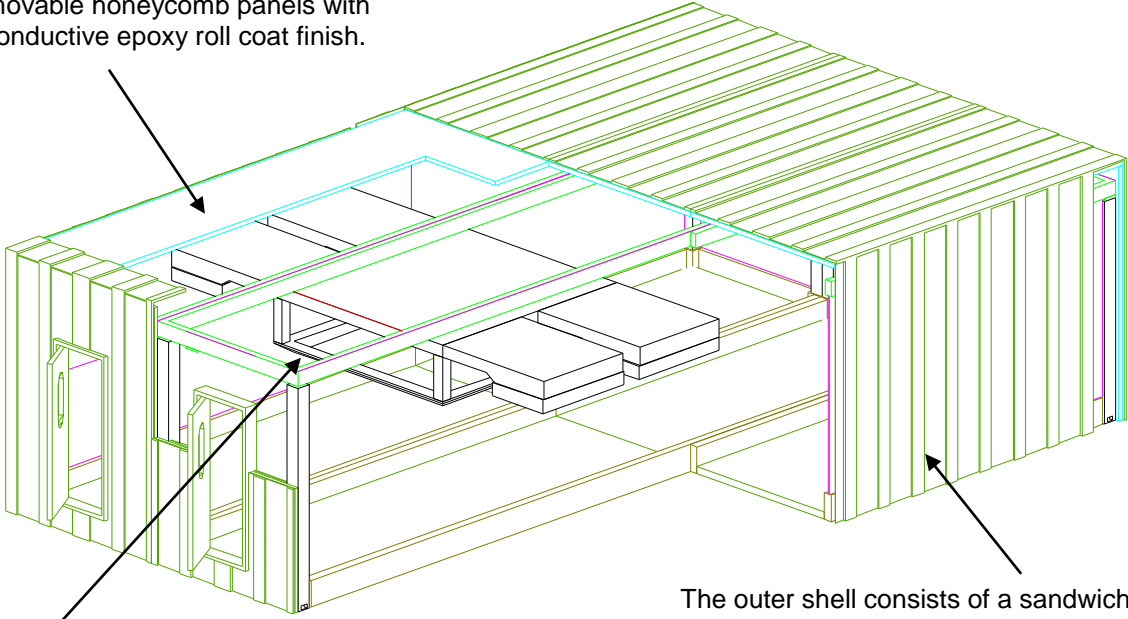

All installations are part of the module and are not removed during transportation.

The outer shell consists of a sandwich layer with 100mm HD insulation, the necessary vapor trap and a waterproof shield.



Different modules can be easily hooked together. Future expansions can be added without major changes at the building



All installations are completed at our facility and tested prior to shipment.